

NEON FLEX

LX-NF-NNR25

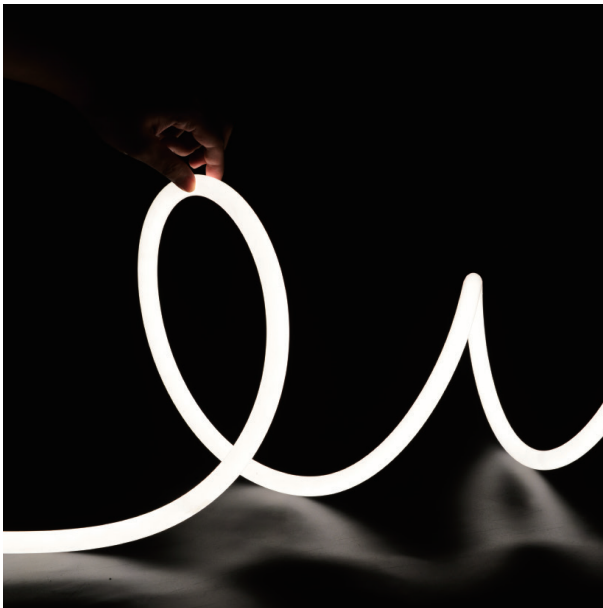

IP 65	IK 08	CRI >90	DC12-24-48V
-----------------	-----------------	-------------------	--------------------

UV RESISTANT	FLAME RESISTANT	SALTWATER RESISTANT	SOLVENT RESISTANT
---------------------	------------------------	----------------------------	--------------------------

5 YEAR WARRANTY	bridgelux	CE	RoHS	36000h
---------------------------	------------------	-----------	-------------	---------------

NEON FLEX

- Light source: high luminous efficiency LED lamp beads, LM80 test certification;
- Process material: high light transmittance, high purity silica gel material, IP65 protection level;
- Optical design: unique optical light distribution structure design, 360° light output uniformly without shadows;
- Appearance design: skin-friendly surface treatment, comfortable touch, good flexibility, and simple shape;
- Product certification: UL, CE, ROHS, UKCA, CB;
- Environmental characteristics: salt solution resistance, acid and alkali corrosion resistance, flame retardant resistance, UV resistance;
- Working/storage temperature: Ta: -25~55°C / 0°C~60°C; Symphony working/storage temperature: Ta: -20~40°C / 0°C~60°C;
- Product application : office lighting, decorative lighting, artistic lighting, modeling contrast;

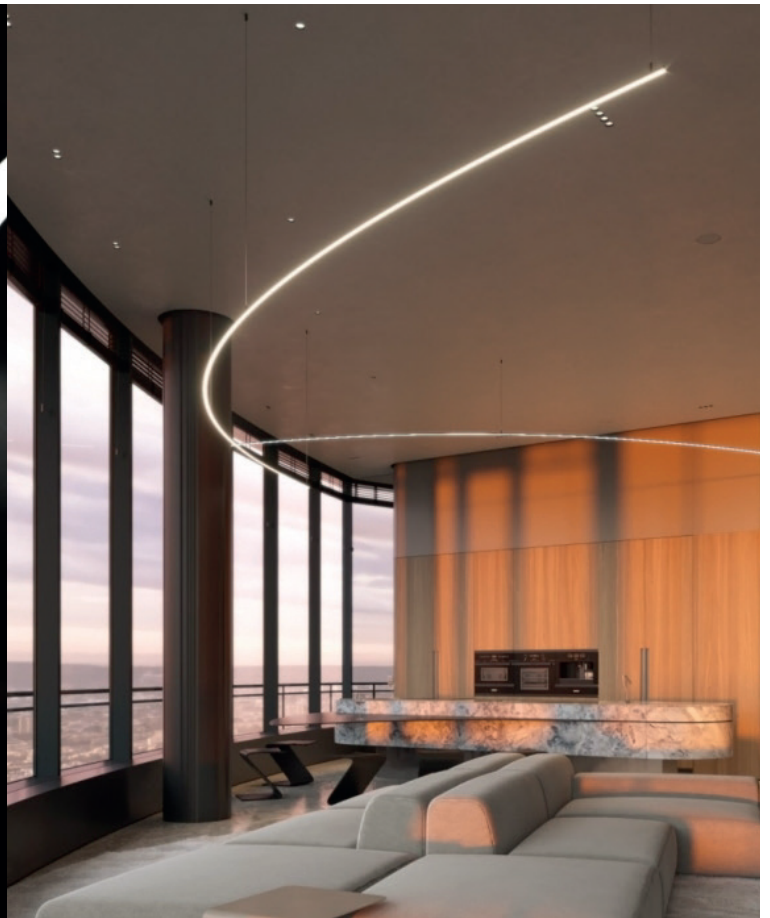

luxio
L I G H T I N G

www.luxio-lighting.com

References

Reference	Rated power (w/m)	Maximum power (w/m)	Input Voltage	Rated current (A/m)	CRI	CCT/K	Luminous flux	IP Rating	Dimensions	Remark	
LX-NF-NNR25	14.4W	16W	24V	0.6	>90	2300K	750Lm	IP65	1000mm - 2500mm - 5000mm	Arbitrary cutting 4LED/11.97mm	
						2700K	950Lm				
						3000K	950Lm				
						4000K	950Lm				
	10W	11W		0.42	/	G 620-630nm	/			No cutting 14LED/41.67mm	
						B 465-470nm	/				
	14.4W	16.5W		0.6	/	RGB	/		No cutting 14LED/50mm		
	14.4W	16W		0.6	>90	2300K~4000K	510Lm		No cutting 24LED/31.25mm		
	17.2W	19.8W		0.72	/	RGBW	950Lm		No cutting 24LED/62.5mm		
	12.5W	13.7W		48V	0.26	>90	2300K		/	20000mm	No cutting 28LED/83.33mm
							2700K		875Lm		
							3200K		1000Lm		
			4400K				1000Lm				
	17.2W	19.8W	0.36	/	RGBW	1060Lm	10000mm	No cutting 48LED/125mm			
	21.6W	23.8W	12V	1.8	/	R	/	5000mm	Arbitrary cutting 2LED/11.11mm		
G						/					
B						/					
RGB						302Lm					

1. The above parameters are tested based on 1m (3.28ft) standard products;
2. The luminous flux is allowed to have an error range of $\pm 10\%$;
3. The above parameters are typical values;

Product mechanical parameters

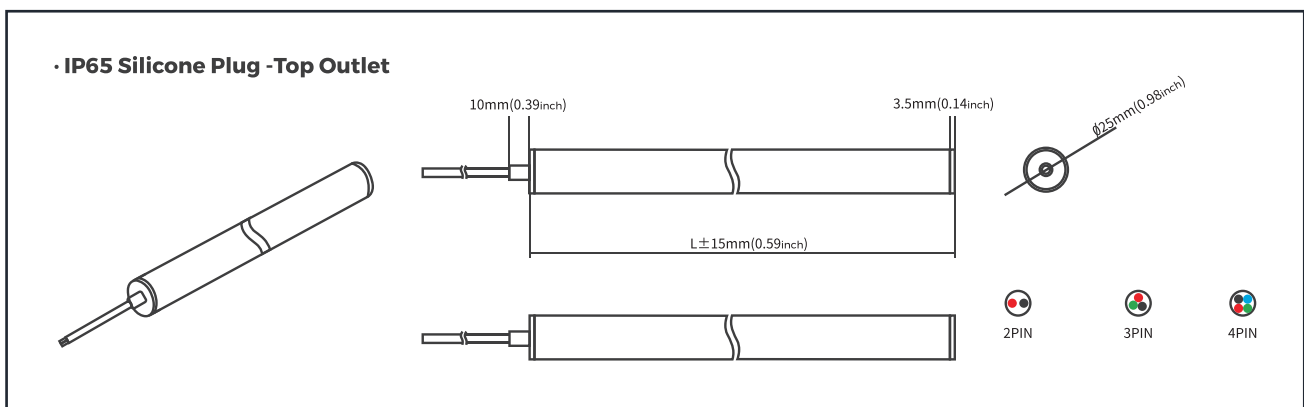

• IP65 Silicone Plug-Side outlet

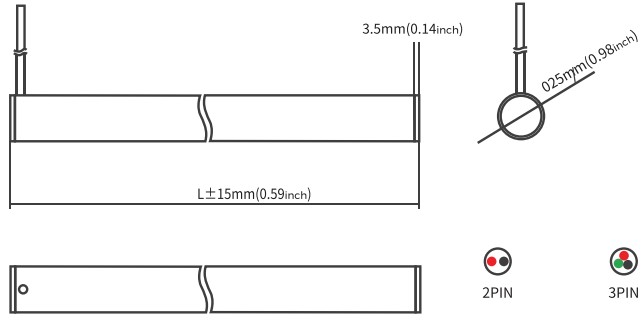
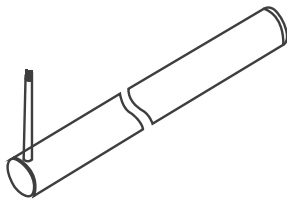

Accessory Information

Installation schematic	Accessories Picture	name	Order model	quantity/ case PCS	net weight (kg)	Per box net weight	Gross weight (kg)	Gross weight (mm)	Remark
/		NNR25 ceiling Fixed installation components	LX-NNR25PI-25	100	0.01	1.00	1.20	250*250*150	Size 1.25*W51.6*H27.8mm . With screws; 3pcs/1M;5pcs/2.5M;8pcs/5M
		Vertical hanging side outlet Install accessory kit (1m)	LX-NNR25VHSI- 1000	16	0.28	4.40	5.29	1285*160*160	LX-NNR25-XXXXBC0100 Round tube 3M ;Wire rope2M
		Vertical hanging side outlet Install accessory kit (2.5m)	LX-NNR25VHSI- 2500	16	0.52	8.40	10.12	2580*165*165	LX-NNR25-XXXXBC0250 Round tube 2.5M ;Wire rope2M
		Hang the top vertically Outlet installation accessory kit (1m)	LX-NNR25VHD1- 1000	16	0.31	4.90	5.79	1285*160*160	LX-NNR25-XXXXBC0100 Round tube 3M ;Wire rope2M
		Vertical hanging from the top Install accessory kit (2.5m)	LX-NNR25VHD1- 2500	16	0.55	8.83	10.55	2580*165*165	LX-NNR25-XXXXBC0250; Round tube 2.5M ;Wire rope2M
		Single-ended vertical ceiling Install accessory kit (1m)	LX-NNR25VCCI- 1000	16	0.23	3.63	4.52	1285*160*160	LX-NNR25-XXXXBC0100 Round tube 3M ;
		Single-ended vertical ceiling Install accessory kit (2.5m)	LX-NNR25VCCI- 2500	16	0.47	7.57	9.29	2580*165*165	LX-NNR25-XXXXBC0250 Round tube : 2.5M ;

Installation schematic	Accessories Picture	name	Order model	quantity/ case (PCS)	net weight (kg)	Per box net weight	Gross weight (kg)	Gross weight (mm)	Remark
		Horizontal ceiling installation components	LX-NNR25LCX-1000	15	0.08	1.20	1.80	1180*125*115	LX-NNR25-XXXXBC0100 LX-NNR25-XXXXBC0500 PC slot 1M ;
		Horizontal hoisting Install components (38mm)	LX-NNR25LHX-0038	96	0.07	6.75	7.35	365*365*190	LX-NNR25-XXXXBC0100 LX-NNR25-XXXXBC0250 LX-NNR25-XXXXBC0500 Round tube :38mm; Wire rope 2pcs, L :2M ;
		Horizontal hoisting Install components (1M)	LX-NNR25LHX-1000	16	0.18	2.88	3.48	1180*125*115	LX-NNR25-XXXXBC0100 Round tube L1M; Wire rope 2pcs, L :2M;
		Horizontal hoisting Install components (2.5M)	LX-NNR25LHX-2500	16	0.33	5.28	6.28	2580*165*165	Round tube L:2.5M; Wire rope 2pcs 2pcs, L :2M ;
		Double-ended vertical ceiling Kits	LX-NNR25VCC1-XX-2	48	0.13	6.05	6.65	365*365*190	LX-NNR25-XXXXBC0100 LX-NNR25-XXXXBC0250 LX-NNR25-XXXXBC0500
		Can be spliced Install components	LX-NNR25DHS-XX	48	0.05	2.30	2.91	365*365*190	LX-NNR25-XXXXBC0100 LX-NNR25-XXXXBC0250 LX-NNR25-XXXXBC0500
		Concealed Install components	LX-NNR25DCX-XX	480	0.01	2.40	3.13	365*365*190	LX-NNR25-XXXXBC0100 LX-NNR25-XXXXBC0250 LX-NNR25-XXXXBC0500
		Can be shaped and hoisted Install components	LX-NNR25DHX-0038	15	0.20	3.00	3.62	415*250*230	LX-NNR25-XXXXBC0100 LX-NNR25-XXXXBC0250 LX-NNR25-XXXXBC0500 Round tube L:38mm ; Telescopic rod:L:0.6M
/		LX-NNR25 Plug set	LX-NNR25GH0-EC	500	0.0004	0.20	1.00	250*250*150	/
/		LX-NNR25 Plug set	LX-NNR25GS0-EC	500	0.0004	0.20	1.00	250*250*150	/

Installation schematic		Accessories Picture	name	Order model	quantity/ case (PCS)	net weight (kg)	Per box net weight (kg)	Gross weight (kg)	Gross weight (mm)	Remark
			Connector	LX-FC-0001	512	0.018	9.216	10.2	365*365*190	Suitable for monochromatic light strip
			Connector	LX-FC-0002	512	0.018	9.216	10.2	365*365*190	Suitable for CCT light strip
			Connector	LX-FC-0003	512	0.018	9.216	10.2	365*365*190	Suitable for RGB light strips
Glue	588G acidic glue		/	LX-PG-0002	150	0.014	2.1	2.4	250*250*150	10ml/pcs
Wire	2P PVC wire (0.5M)		/	LX-WS-0001	150	0.01541	2.31	2.61	250*250*150	Suitable for monochromatic light strips (Use the top-out line)
Wire	2P PVC wire (2M)		LX-WS-0002	125	0.0616	7.7	8	250*250*150		
Wire	4P PVC wire (0.5M)		/	LX-WS-0003	150	0.0194	2.91	3.21	250*250*150	Suitable for RGB strips (Use the top-out line)
Wire	4P PVC wire (2M)		LX-WS-0004	125	0.0776	9.7	10	250*250*150		

Precautions

- Please use an isolated power supply to drive the LED light bar, and the ripple of the constant voltage source is less than 5%. Do not use resistance-capacitance step-down, non-isolated power supplies to drive the LED light bar.
- In actual applications, the power supply should reserve 20% of the margin (it is recommended to use only 80% of the power) to ensure sufficient voltage to drive the product.
- Please operate carefully, do not touch the AC power terminal when the power is on to prevent electric shock.
- Pay attention to the positive and negative poles of the power cord, and do not connect it wrongly. Whether the voltage of the power supply and the product are the same, so as to avoid damage to the product.
- During the installation process, please avoid scratching, twisting and irregular bending of the product, otherwise it may cause irreparable damage to the product.
- In order to ensure the life and reliability of the light strip, please do not bend it in an arc with a radius of 120mm or less. A too small bending radius will damage the product itself.
- If the actual application length exceeds the specified use length, it will cause the lamp belt to overload and heat, and the brightness is uneven.
- In order to prevent your eyes from being hurt, try to avoid staring at the light-emitting surface of the light bar for a long time.
- Non-professionals are prohibited from installing, disassembling and repairing the product.
- It is strictly forbidden to use any acidic or alkaline adhesives to fix products (including but not limited to glass glue, etc.).
- Different IP grades are used in different scenarios, and IP65 is not suitable for immersed environments.
- Products of different sizes and specifications under the same color temperature value due to structural differences, the final color of the product is slightly deviated, and it needs to be confirmed before use.
- Light strips that can be cut arbitrarily need to be glued or plugged after cutting. Colored light and color temperature are strictly prohibited to be cut to avoid damage to the lamp due to cutting.
- Please use professional cutting tools when cutting.



It is forbidden to wrap objects less than 150mm

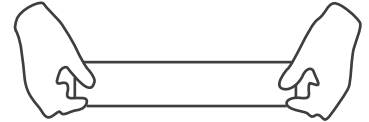

NO stretching

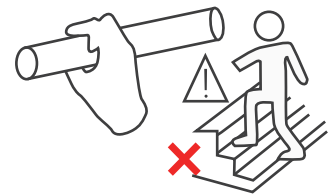

No trampling